

Bible Street Community Garden 2024 Season Handbook

We are on a MISSION

Celebrating our 16th anniversary in 2024, Greenwich Community Gardens offers town residents an opportunity to create sustainable gardens, while promoting garden education and demonstrating diversity. We are stewards of three thriving gardens with the active participation of members who are dedicated to organic gardening, sustainable living, and the belief that community gardens can change the health and quality of life of the gardeners they serve. The three gardens are managed by all-volunteer Steering Committees. **We stick to our organic principles.**

Gardening Success: a play in five acts



Every gardener gets one 4'X8' raised bed plot filled with organic topsoil.

If you want this to be a fantastic and successful experience, plan to visit and tend your garden twice a week all season. Especially in August and September. FOR REAL.

Act I: Prepare and plant. Act II: Thin and stake tall plants. Act III: Water, weed, look out for pests. Act IV: Harvest and enjoy. Act V: Cleanup and shut down the garden.

Come for the gardening, stay for the community!

This is what happens! Friendships, learning, food, outdoor fun. Supporting the community means putting in 10 hours of volunteer help (AKA Party time!).

Plan to learn about your soil and what makes for healthy soil. Respect for our neighbors means pulling our weeds, keeping the pathways clear and clearing up any pest or disease issues BEFORE they spread to the next bed.

If you see something, for goodness sakes, say something! Hey, we're all volunteers here. We love folks who like to help!

A history of feeding our neighbors

Some of the garden plots are used to grow food for the Neighbor to Neighbor Food Pantry. We deliver hundreds of pounds of fresh, organic food each year. This is done by one of the volunteer teams. Gardeners who work on this team also have their own plots for their own gardening enjoyment.



How does all this volunteer time work out?

All of us help maintain the garden-at-large for a minimum of 10 hours between February and November.

This work is organized into service days like garden opening and closing days, and Scrub and Grub work days. Always fun, and stay for lunch!

We also sign up with two volunteer teams (Composting, Neighborly Harvest, Events, Garden Health, etc.) which will have projects that need volunteers. Your team leader will get in touch with you in April.

Log your hours on the website, or in the binder in the shed. Easy.

What if I am a beginning gardener and/or would appreciate some guidance?

Piece of cake! Just let us know and we will help pair you up with one of our gardening mentors. And once you get started you'll find lots of gardeners are happy to answer questions and share experiences.

We hold several orientation workshops in the spring so everyone can attend one and get the lay of the land. Most questions can be answered then.



What can I plant when?

Cool weather crops can start as early as April or as late as September. Warm weather crops want to wait until late Spring. See our website for lists and examples and MORE! Visit greenwichcommunitygardens.org, and look under the Library tab.

Organic communities are works in progress

We are all working towards a healthy and productive garden. It's harder to be organic and all natural, it's easy to spray Roundup. We learn more every year and try to create better outcomes every year.

Get to know some of your garden neighbors. It's a big help to have a few garden buddies you can call on if you need help with watering or anything over the summer.

They'll appreciate you being available too. Plans change, vacations happen - just have a plan for keeping your plot in good shape.

WE ROCK SUSTAINABILITY!

We harvest rainwater in our big barrel, we compost like CRAZY, both hot and cold, and our beehives keep the pollinators happy and buzzing.



This is a LEAVE NO TRACE natural area.

Please bring any packaging, plant tags, plant pots, etc. that you bring into the garden back OUT of the garden. That goes for diseased or infested plant materials too. Please bag them and put them in your home garbage.

ALL HANDS ON DECK

Be on the lookout for problems. If something looks broken or needs attention, let the garden director know.

Please keep the garden gate closed, even if you are working inside the garden. There is a lot of nature out there! Last one out locks the gate.

If you are notified by the Garden Health team that there is a problem in your plot, please plan to address that problem within three days. If you are not able to, CALL A BUDDY!

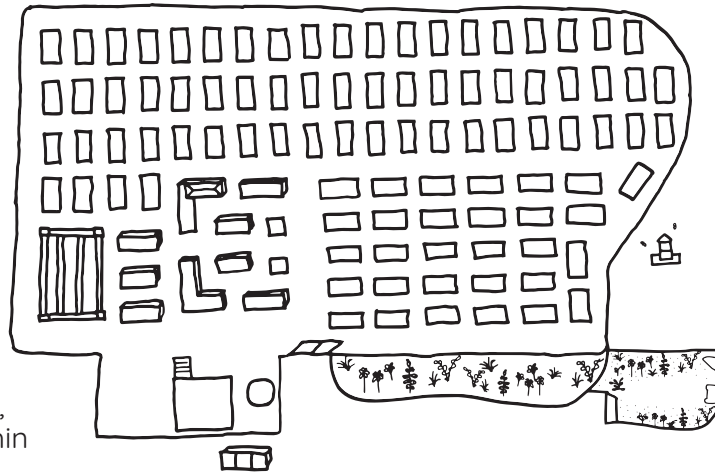

Love thy neighbor

- Thou shalt not plant things that will grow so tall and bushy they shade your neighbor's plot and it becomes a problem, or that climb up the fencing.
- Thou shalt not install tall and large items that shade your neighbor's plot and become a problem.
- Thou shalt keep the pathways around your plot weed free and clear. Add some wood chips if needed. They're free!
- Thou shalt not help yourself to any food or produce in thy neighbor's plot, even if it is ripe or overripe and you think it needs to be picked right now.
- Please return all the tools you use to the shed, cleaned off if necessary.
- Bring your own gloves and a bag to take away any debris that you will not be composting on site. All the rest is provided for.
- Please do not bring pets inside the garden gate.

Beetles and Slugs and Mildew, OH MY!

Yes, pests will show up, powdery mildew or other diseases will try to take hold, but we will rise up! We will defend our soil!

The Garden Health Team keeps an eye on things and will let you know if you need to take action. That mostly means picking the bugs off your plants, removing any diseased leaves, and getting that nasty stuff into a bag and OFF the property. Organic treatments are our second best defense, and we do that too.

Banned substances. Really?

Well, not many. Please do not grow mint; it spreads through its roots and will become a large plant in your plot and in the plots of your neighbors. Pumpkins are also not to be planted because they tend towards megalomania.

How can I get in touch with someone in the garden?

Please call the garden director if something needs attention. Contact info is below. You can also check the laminated listing in the shed that gives all the gardener names,

email and cell phone numbers, organized by plot address. It's a nice idea to make a note of your immediate neighbors in case you decide to reach out.



Contacts and Resources

Garden Director

Terri Browne Kutzen
203-253-6264 (cell)
tbk1@optonline.net

Email and Website

info@greenwichcommunitygardens.org
www.greenwichcommunitygardens.org